

MAC

METAL ARCHITECTURAL



Installation guide

MS-1 (WALL MOUNTED)



PROTECTION

The material may have sharp edges. We recommend using protective equipment, including safety boots, a helmet, goggles, and gloves.



WARRANTY

FOR THE WARRANTY TO BE APPLICABLE, INSTALLATION MUST BE CARRIED OUT IN ACCORDANCE WITH THE STANDARDS SET OUT IN THE UPDATED BUILDING CODE, ALONG WITH THE MANUFACTURER'S RECOMMENDATIONS.

In the event that a problem occurs during the installation of the profiles, please notify the supplier immediately before the installation of 144 ft² (2 boxes), to make sure that the warranty still apply. Over 144 ft², the responsibility for the installation lies with the installer.

INSPECTION

When you receive your order, it is important to inspect the product immediately. If there are any issues with your order or if panels arrive damaged, you should inform your supplier as soon as possible.

HANDLING

Handle the box with care, ensuring to move it only vertically. Carry the box and panels standing on it's edge, instead of laying flat, to preventing it from bending and warping.

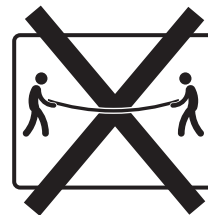

STORAGE

To keep the physical properties of MAC Metal Architectural siding intact, it is important to follow some basic rules for storage.

If the panels cannot be installed immediately upon delivery, store them indoors in a dry, well-ventilated area. Customers are responsible for the risks involved with storing panels outdoors. If the material must be stored outside, here are a few recommendations:

Place the panels in an area with no direct exposure to the sun or to extreme temperatures, as these factors may cause the protective film to further adhere to the panels. Making it difficult to remove and may leave glue marks on the panels.

We also recommend using a tarp to protect the materials from temperature fluctuations.

PRODUCT TESTED

- Tested as per CAN/ULC-S135 for use in non-combustible constructions

INSTALLATION WARNING



« R SHEATHING »

Installation of MAC Metal Architectural siding on Zip System, Insulated R-Sheathing or similar foamed backed panels is not recommended. This type of sheathing does not offer a rigid surface for MAC Metal Architectural product. This type of sheathing can move and deform under adverse weather conditions and excessive exposure to the sun. The result can lead to warping or "oil canning".

1. Tools

To complete the work correctly, you will require a MAC Metal Cutter (guillotine), a folding tool, a drill, and a pair of sheet cutters. You will also need a level, a tape measure and safety goggles. MAC Metal Architectural equipment is available at the MAC supplier nearest you.

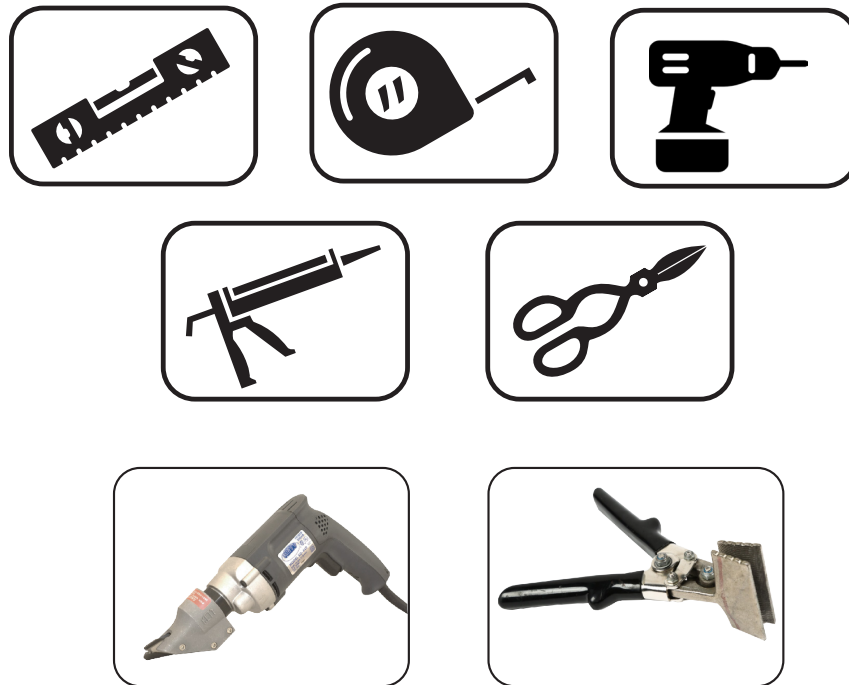

2. ACCESSORIES

Here is the list of required accessories required for the installation of Versa and/or Metal Block profiles:

- Wood screws or MAC metal screws depending on the type of project
- Waterproofing membrane
- Self-adhesive elastomeric membrane
- Steel roll
- Mouldings

It is highly recommended the screws provided by MAC Metal Architectural be used with our siding.

In addition, the screws must meet the STM B-117 2000h standard. The use of MAC screws designed for these profiles is highly recommended by the manufacturer.

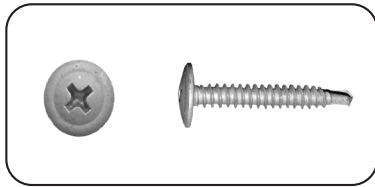

Self-drilling MAC
Metal Screw

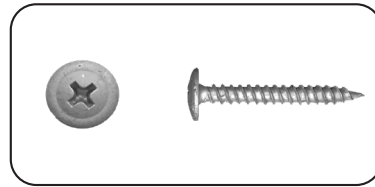

MAC Wood Screw

Molding & Trims MS 1

No. M01A

J Trim

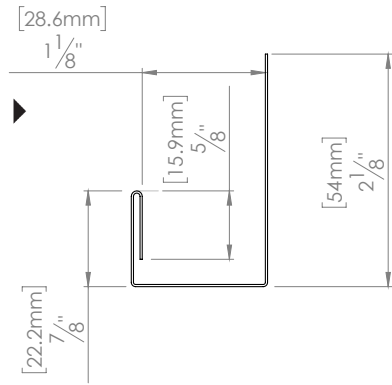

No. M02A

J Trim double

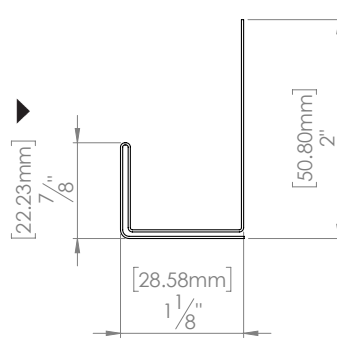

No. M03A

Extended J Trim w/variable

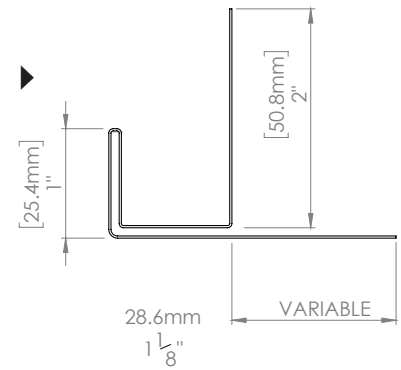

No. M51A

Drip Flashing

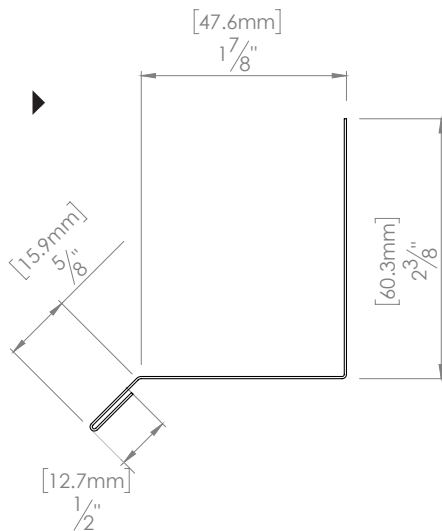

No. M50A

Drip Flashing w/90° angle

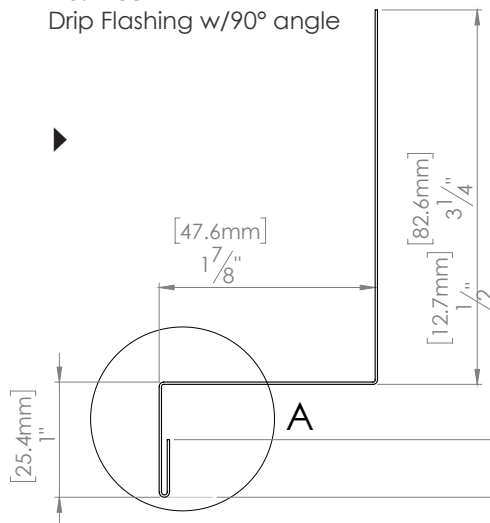

No. M54A

Double Drip Flashing
w/90° angle

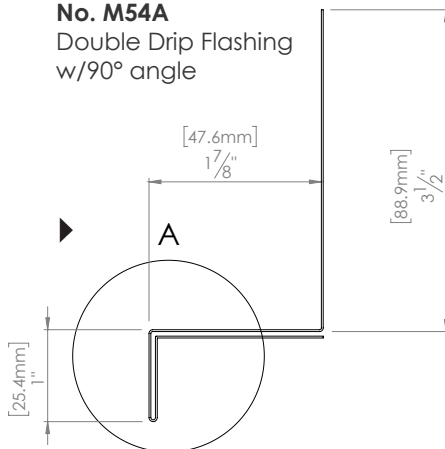

No. M57A

Extended Drip Flashing
w/90° angle

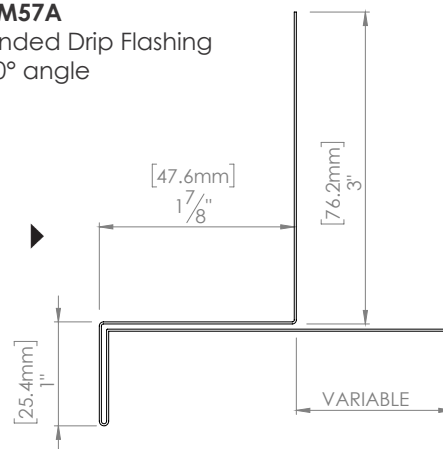

Molding & Trims MS 1

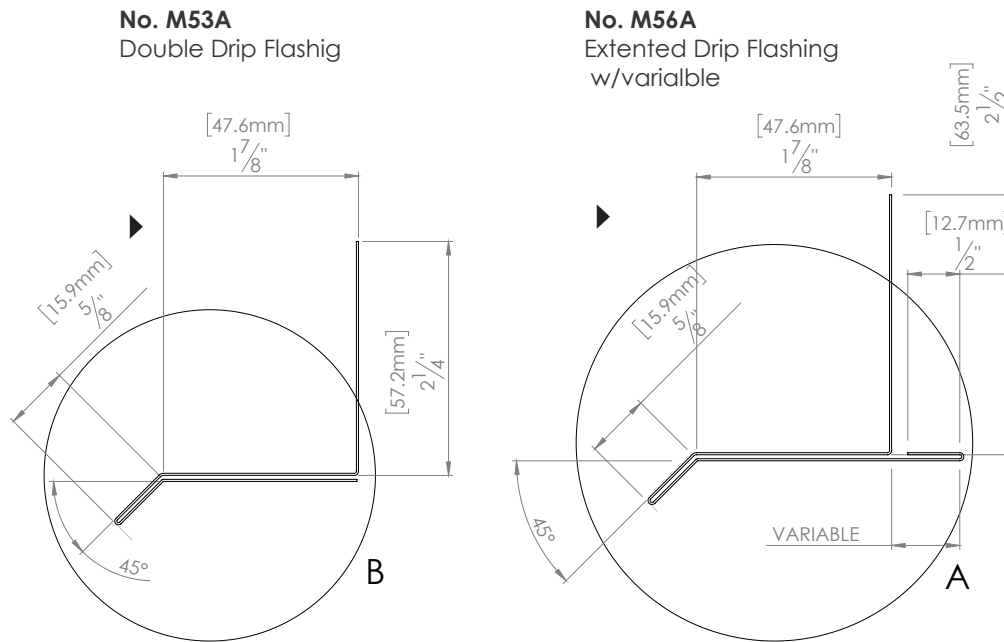

3. PREPARATION

Before beginning the first step, be sure that the construction of the surface to be covered with MS 1 siding complies with all current industry standards.

In addition, please check with your local authorities regarding the installation of metal or wood furring. If they are not needed, then it's okay not to install them.

Metal Furring should be of 18–20-gauge steel. Wood furring strips a minimum of 1" x 3".

Siding panels may be installed on 7/16" – 5/8" Plywood or O.S.B. over a moisture resistant barrier. Please note that windload testing was conducted using 5/8" Plywood as the substrate.

Preparing a wall - Step 1

- A. It is strongly recommended to install wood or steel furring at a 45° angle every 12 inches on center, which will ultimately give you 16 inches on center for fastening the panels.



- B. To install the drip flashing, measure the width of your wall. Cut your drip flashing to this measurement. Use 1 1/8 inch flat head MAC wood or metal screws. Secure the drip flashing with a screw. Next level the drip flashing and then secure the rest in place with flat screws.



- C. For the inside corner, measure from the top to the bottom of the wall. Use this measurement to cut the inside corner and install it in place.



- D. For the outside corner, measure from the top to bottom of the wall. Use this measurement to cut the outside molding and install the outside corner in place.



- E. For the J-Trim take the measurement from left to right at the top of your wall. Cut the J-Trim molding to that measurement and install it with screws in it's place.



- F. To prepare the outline of a window or opening, take the measurements of the opening. Cut the drip flashing for the top of the opening, then cut J Trim for the other 3 sides, the bottom, the left and right sides. Install the moldings around the opening to form a frame for your panels.

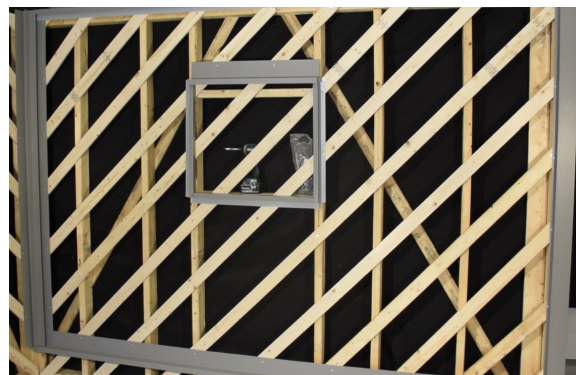

Panel Preparation - Step 2

A double fold at the bottom or sides of the panel is necessary to provide strenght to the panel.

Bottom of the panel

- A. Before double folding, cut a small triangle 1 inch long to avoid denting the panel during folding. Fold the bottom of the panel with the MAC folding bar. Then, use a hand seamer to finish the double fold. Cut the male and female sides that exceed the fold, taking care of bending the male side to hide the end of the edge.



- B. Once the fold is completed, cut the edges to the right and left of the fold. The panel is ready for installation.

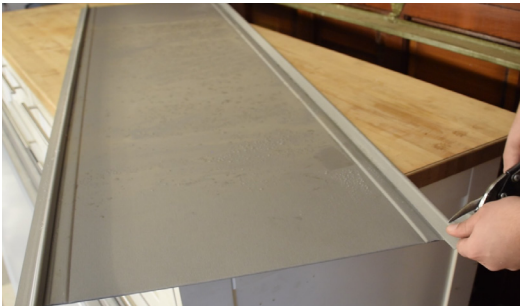

Top of panel

- A. Repeat the same steps for cutting the small 1-inch long triangle to avoid denting the panel during folding.
- B. Cut at an angle to facilitate the insertion of the next panel.
- C. Bend 90 degrees towards the outside of the wall and cut the male and female.



Installing a panel - Step 3

To facilitate installing sheet, start by attaching the male part to the female part from the top of the sheet and work your way down to the bottom of the sheet, taking care to screw the male part to the female part every 16 to 24 inches.

- a. Put the top of the panel in the J-trim first
- b. Move the panel to the outside corner
- c. Make sure that you are level and square
- d. Secure the panel with screws
- e. See installation videos on MAC website or YouTube Channel



a.



b.



c.



d.

Sheet finishing - Step 4

Sometimes it is necessary to cut the sheet to finish in a J trim, an outside and inside corner.

- a. Take your measurements
- b. Cut the sheet 1 inch longer than the intended length.the wall.
- c. If you are on the windward side of your project, you can add a joint sealer to prevent the panels from detaching.
- e. See installation videos on MAC website or YouTube Channel



Installing around a window - Step 5

For the bottom and sides of the window repeat the same step as number 2. For the top of the window it is important to double tap and cut off the excess from the sides.

- a. Take your measurements
- b. Cut your panel to size
- c. Install the panel
- d. Voir les vidéos d'installation sur le site Web de MAC ou sur la chaine YouTube

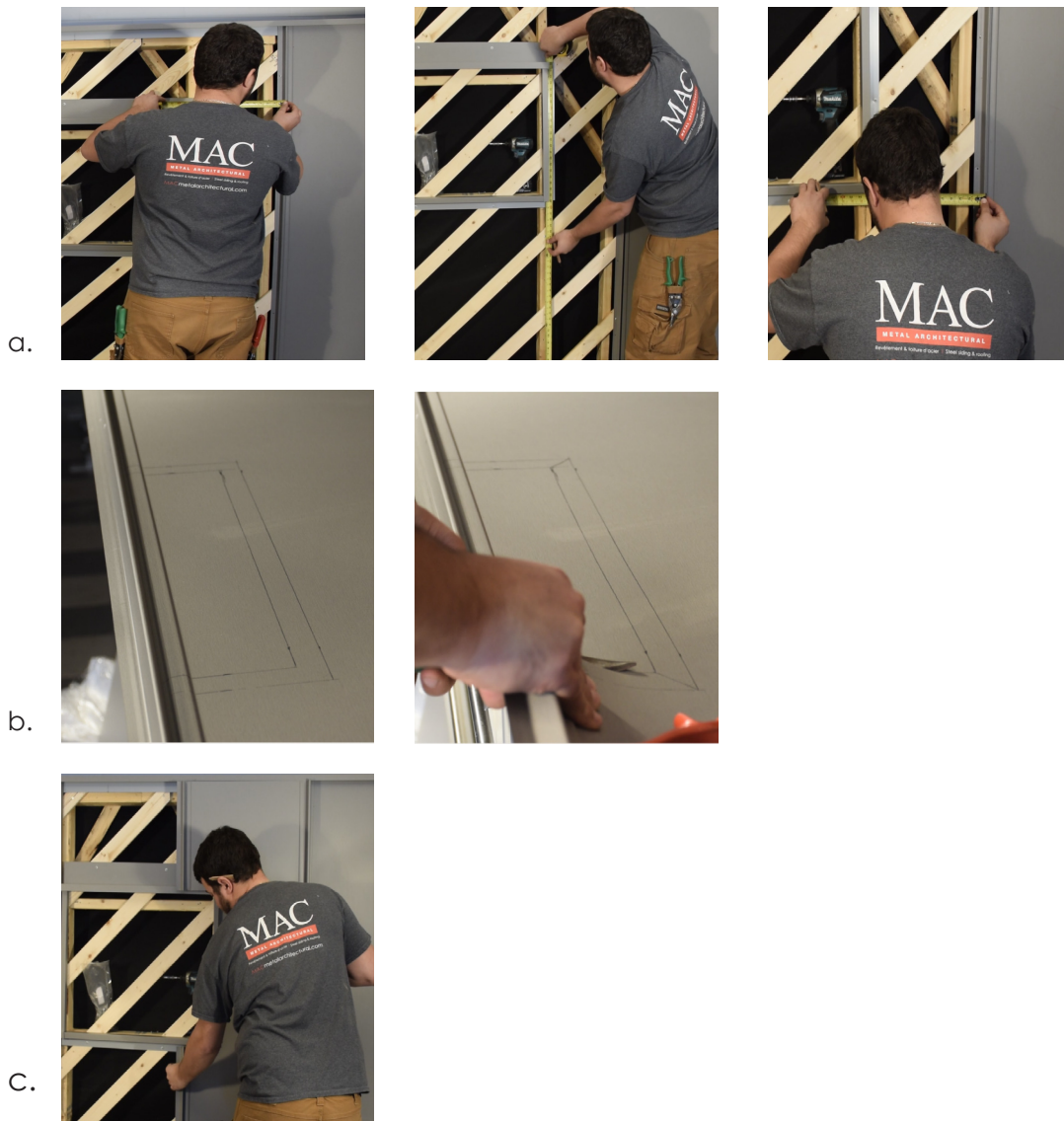

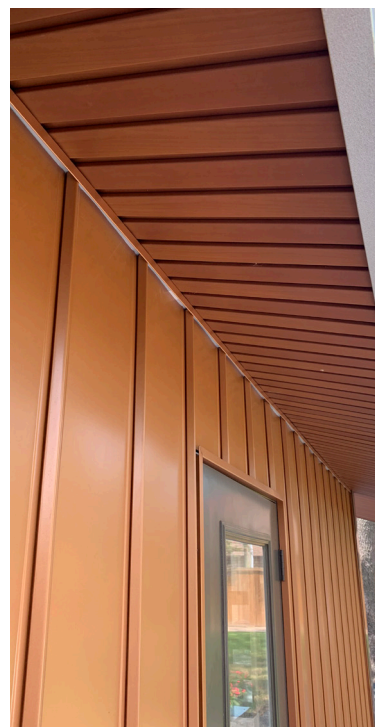

For more information on the installation of the MS 1, MS 1 Modular, MS 2 and MS Authentic profiles in wall installation visit the PRO section of our website, MACmetalarchitectural.com. You will find a bank of technical information on the profile, such as a series of installation videos, molding booklets and access to technical drawings.

MAC
METAL ARCHITECTURAL

MAC Metal Architectural
3099, Bernard-Pilon (Quebec) J3G 4S5
T. 450 464-5486 | T F. 450 464-4538
info@MACmetalarchitectural.com
MACmetalarchitectural.com